

Social Story

Prepare for your visit through a visual Social Story about experiencing the Museum. A paper copy of this Social Story is available at the Admissions Desk; you can review the CMA Social Story on any chairs in the Atrium.

Personal Items

You can use personal items to make your visit more enjoyable. Other visitors may also have these items in the galleries:

- Earphones
- Technology
- Stuffed animals and fidget objects
- Photography devices (without flash, tripods, or selfie sticks)
- Pencil and paper (pencil sketching may occur in the galleries)
- Wheelchairs, strollers, and other mobility items

Tip: There are wheelchairs and strollers available for use at no charge at the Admissions Desk.

Bathrooms

- CMA has two individual, fully accessible restrooms on the first floor.
- There are restroom stalls near the Schokko Café.
- The Comfort Room is located in the Center for Creativity. It includes two comfy chairs, a sink, and a diaper changing stations. Everyone is welcome to use this space.
- All CMA restrooms include hand dryers and paper towels.

Tip: The sinks in restrooms located in the new Walter Wing feature hand dryers attached to the faucet —watch out for a quick burst of air.



Food & Drink

You may bring your food and drink into CMA and enjoy it in:

- The Atrium
- The Sculpture Garden
- Derby Court

You may also purchase food at or dine in **Schokko Café**, located on the right when entering the Museum. The Café offers:

- Soups, appetizers, salads, sandwiches, entrées, and desserts
- Child-friendly options
- Vegetarian options

Tip: The Schokko Café is busiest from 12:00 pm – 2:00 pm

Hours & Admission

General Admission

Tuesday–Sunday	10:00 am – 5:00 pm
Thursday	10:00 am – 9:00 pm
Monday	Closed

Members	FREE
Adults	\$18
Seniors (60+)	\$9
Students (18+)	\$9
Students (4–17)	\$5
Children 3 & under	FREE
Sundays	FREE
Thursdays	\$5
(5:00 pm – 9:00 pm)	

Special Exhibition Admission

Members	FREE
Non-members	\$7

Tip: CMA is most active on weekends, and the quietest times are Tuesdays-Fridays from 2:00 pm – 5:00 pm.

Questions & Feedback

We would love to hear about your experience at CMA today. Please let us know how we can make your next visit more enjoyable.

Contact Information

Hannah Mason-Macklin
614.629.0357
Hannah.MasonMacklin@cmaohio.org



480 E. Broad Street
Columbus, OH 43215
614.221.6801
columbusmuseum.org

Visitor Guide

Tips & Resources for visitors with ASD and Sensory Sensitivities

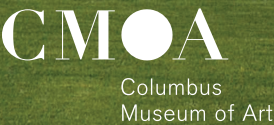

Welcome!
We’re glad you’re here.

Please let us know how we can make your visit more enjoyable today.

Tip: Need help? Anyone wearing a green badge can help you anywhere in the Museum today. Tell us how best to communicate with you.

Connect with us on Facebook, Twitter, and Instagram: @ColumbusMuseum

First Floor

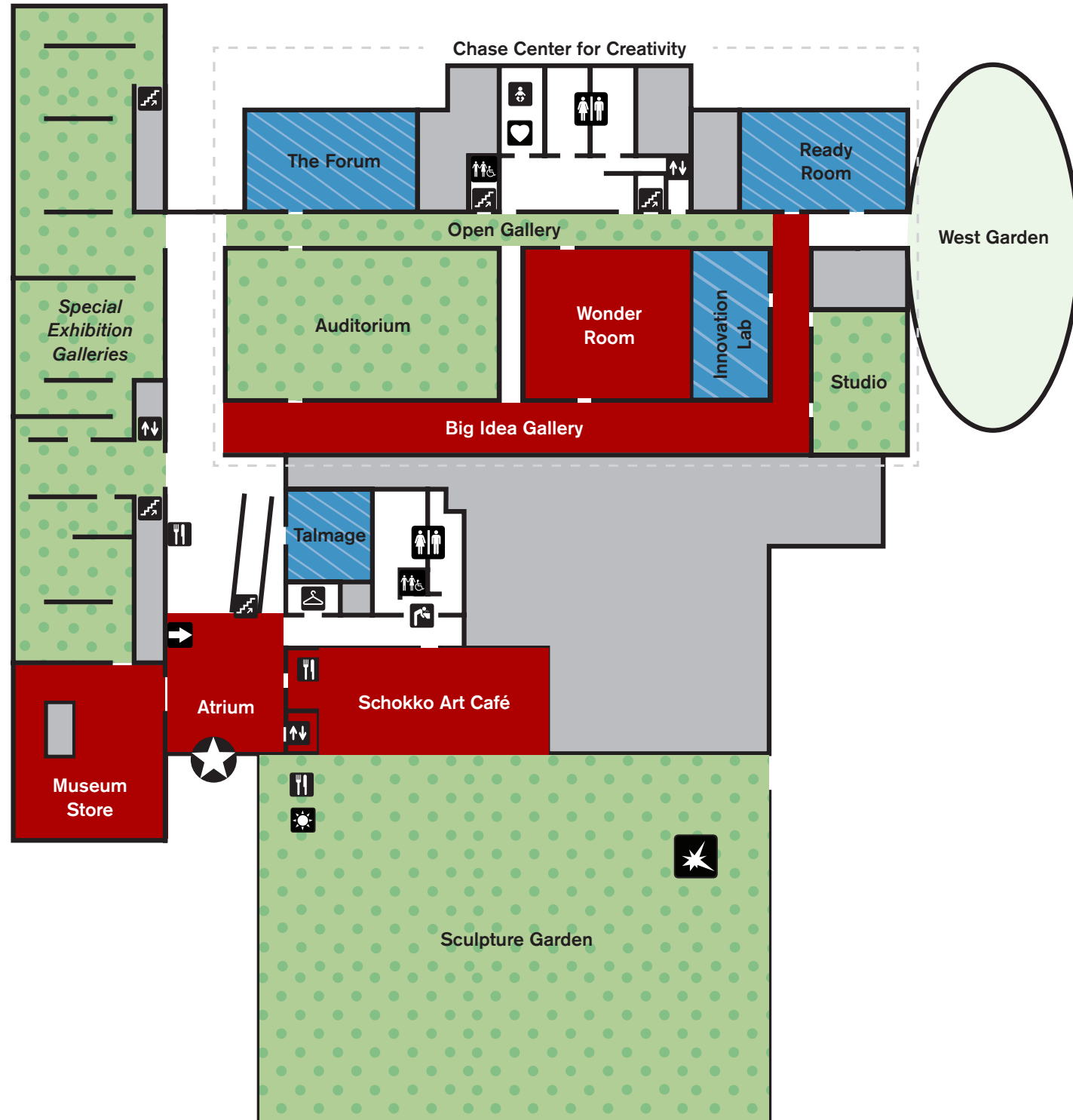

Second Floor



- Solid Red = Noisy and crowded spaces
- Green Dots = Sometimes noisy and crowded spaces
- Blue Stripes = Quiet, less crowded spaces

Key

- Museum Entry
- Admissions + Help Desk
- Coat Room
- Stall Restrooms
- Individual Restroom
- Drinking Fountain
- Stairs
- Elevator
- Food + Drink–Allowed Area
- Outdoor Area
- Comfort Room
- Art with a Sensory Aspect